

LEGEND

CONCRETE	WALL LIGHT
GRASS	SQUARE CEILING LIGHT
ASPHALT	BOLLARD
GROUND	MAIL BOX
METAL	VENT
GRANITE	DOUBLE PARKING METER
EXPOSED AGGREGATE	SINGLE PARKING METER
STONE	DECIDUOUS TREE
FIBER GLASS	DOOR
VEGETATION	BIKE RACK
FEA GRAVEL	SIGN
BRICK	MONUMENT FOUND COPPER
DRAINAGE MANHOLE	MONUMENT FOUND IRON PIPE
SANITARY MANHOLE	MONUMENT FOUND PK NAIL
ELECTRIC MANHOLE	TEST HOLE/TEST PIT
COMMUNICATION MANHOLE	TC TOP OF CURB
TELEPHONE MANHOLE	BC BOTTOM OF CURB
UTILITY MANHOLE	FL FLOWLINE
WATER MANHOLE	TW TOP OF WALL
FIRE HYDRANT	BW BOTTOM OF WALL
SIAMESE CONNECTION	CLF CHAIN LINK FENCE
WATER VALVE	WF WROUGHT IRON FENCE
WATER METER	MF METAL FENCE
WATER SPIGOT VALVE	WDF WOOD FENCE
MONITORING WELL	FF FINISH FLOOR
DOWN SPOUT	S/W SIDE WALK
CLEANOUT	C&G CURB AND GUTTER
ROUND DRAIN	rec RECORD
UTILITY POLE	mst MEASUREMENT
TELEPHONE CALL BOX	TH# TEST HOLE
POLE BASE	MAUL# MID-ATLANTIC UTILITY LOCATION
GAS VALVE	---C--- UNDERGROUND COMMUNICATION
GAS METER	---E--- UNDERGROUND ELECTRIC
ELECTRIC METER	---G--- UNDERGROUND GAS
ELECTRIC STRUCTURE	---W--- UNDERGROUND WATER
CARD READER	---U--- UNDERGROUND UTILITY
SECURITY CAMERA	---OHE--- OVERHEAD ELECTRIC
ELECTRIC POLE	---CATV--- UNDERGROUND CABLE TV
GUY WIRE	---STW--- UNDERGROUND STORM WRENER
SINGLE COBRA LIGHT POLE	---+--- FENCE LINE
DOUBLE COBRA LIGHT POLE	---O--- HAND RAIL
3 SQUARE GLOBE LIGHT POLE	---+--- RAIL ROAD
	--- --- PROPERTY LINE

EXISTING CONDITIONS NOTES

1. TOPOGRAPHIC AND PROPERTY LINE INFORMATION SHOWN WAS TAKEN FROM A SURVEY PROVIDED BY WILES MENSCH CORPORATION-DC.
2. BOUNDARY LINE SHOWN ON PLAN IS FOR CONSOLIDATED PROPERTIES.
3. PEPCO AND VERIZON EASEMENTS ARE NOT SHOWN FOR PLAN CLARITY.

PART B - NOT PART OF STADIUM PUD SUBMISSION, DESIGN INTENT SHOWN FOR REFERENCE ONLY

PUBLIC REALM - NOT PART OF PUD SUBMISSION, DESIGN INTENT SHOWN FOR REFERENCE ONLY

DISTRICT OF COLUMBIA RESPONSIBLE FOR DESIGN OF PUBLIC REALM

POPULOUS
Marshall | Moya Design

POPULOUS
1000 15th St NW
Washington, DC 20004
Tel: 202.691.1000
www.populous.com



DC UNITED SOCCER STADIUM
100 Potomac Avenue, SW
Washington, DC 20024

100% PUD SUBMISSION

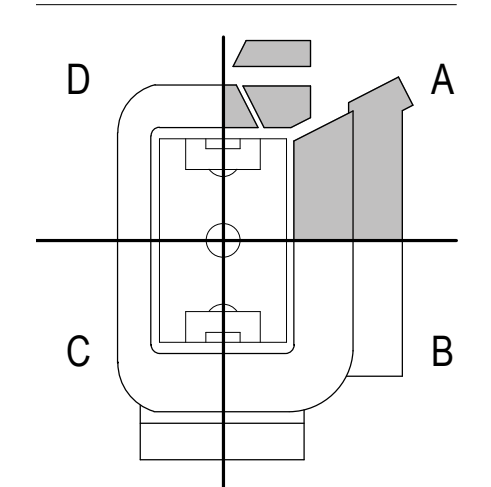

POPULOUS
2024
EXISTING CONDITIONS PLAN

SCALE: 1" = 30'
2.01



EXISTING CONDITIONS PLAN
SCALE: 1" = 30'

GRAPHIC SCALE

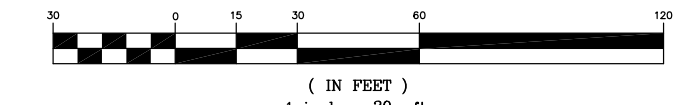

FOR REFERENCE ONLY - NOT FOR CONSTRUCTION

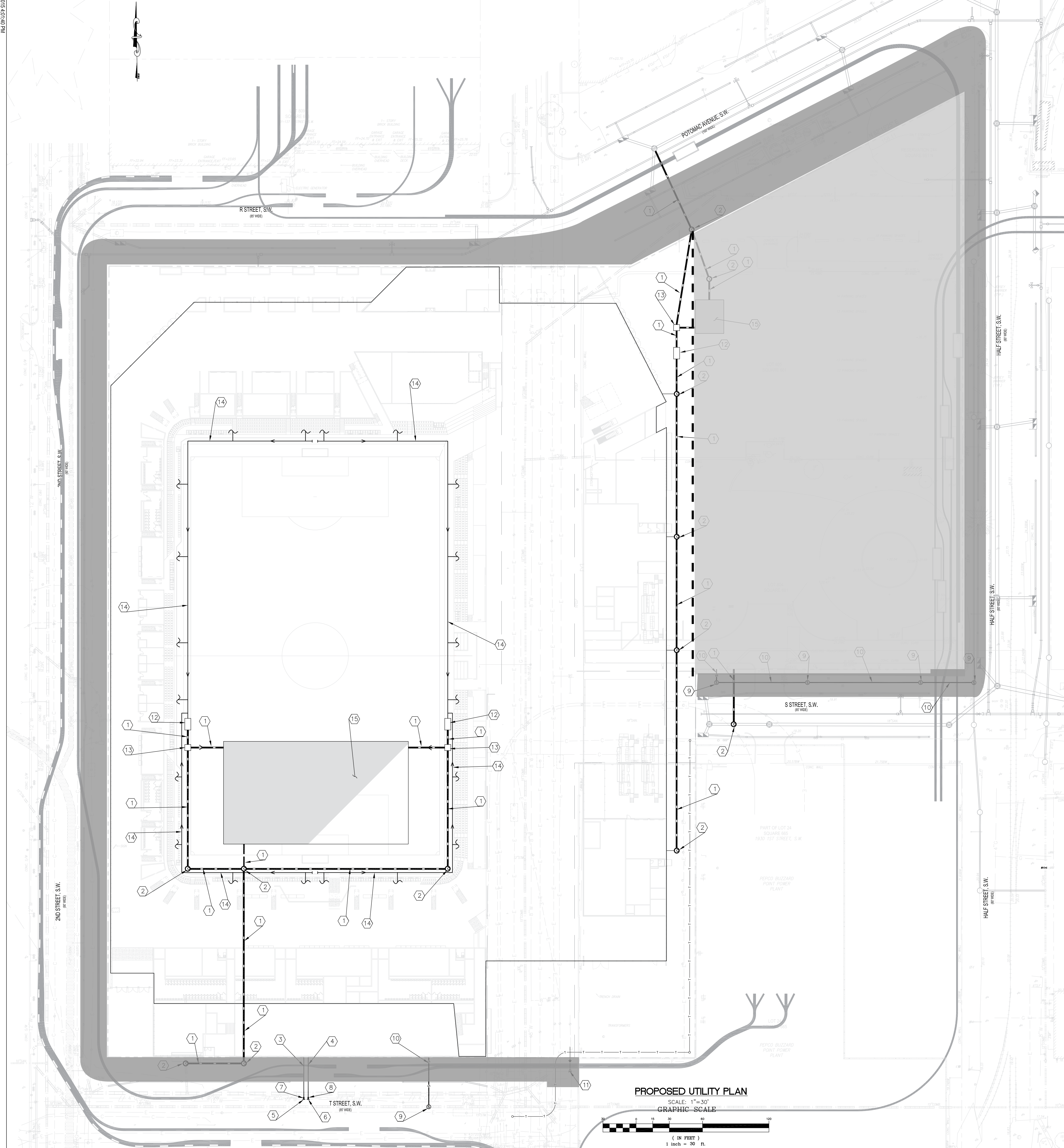

SITE UTILITY LEGEND

- ① INSTALL NEW RCP STORM DRAIN
- ② INSTALL NEW STORM DRAIN MANHOLE
- ③ INSTALL NEW 6" DUCTILE IRON FIRE LINE
- ④ INSTALL NEW 8" DUCTILE IRON DOMESTIC WATER LINE
- ⑤ INSTALL NEW 12"x6" TEE WITH THRUST BLOCK OR RESTRAINTS
- ⑥ INSTALL NEW 12"x8" TEE WITH THRUST BLOCK OR RESTRAINTS
- ⑦ INSTALL NEW 6" GATE VALVE
- ⑧ INSTALL NEW 8" GATE VALVE
- ⑨ INSTALL NEW 48" DIAMETER SEWER MANHOLE†
- ⑩ INSTALL NEW 10" DIAMETER PVC SANITARY SEWER LINE
- ⑪ NEW GAS SERVICE CONNECTION
- ⑫ INSTALL DEBRIS/SCREENING STRUCTURE
- ⑬ INSTALL FLOW SPLITTER STRUCTURE
- ⑭ INSTALL ROOF DRAIN COLLECTION SYSTEM
- ⑮ INSTALL UNDERGROUND INFILTRATION BASIN

UTILITY PLAN NOTES:

1. UNDERGROUND UTILITY LOCATIONS SHOULD BE CONSIDERED APPROXIMATE. THE CONTRACTOR SHALL CALL MISS UTILITY AT 1-800-257-7777 AT LEAST 48 HOURS PRIOR TO ANY EXCAVATION OR CONSTRUCTION.
2. ALL UTILITY WORK IN PUBLIC SPACE SHALL BE DONE USING CUT/COVER CONSTRUCTION. NO OPEN TRENCHES WILL BE PERMITTED TO EXIST OVERNIGHT IN PUBLIC SPACE.
3. THE EXISTING SURROUNDING FACILITIES ARE TO REMAIN IN OPERATION WHILE CONSTRUCTION WORK IS BEING PERFORMED. ALL UTILITY WORK SHALL BE PERFORMED IN AN EXPEDITIOUS MANNER TO MINIMIZE ANY IMPACTS ON EXISTING FACILITY OPERATIONS.
4. EXISTING CONTOURS ARE NOT SHOWN FOR PLAN CLARITY. ALL UTILITY VALVES, MANHOLES, AND CLEAN OUTS SHOWN OR NOT SHOWN ON THIS PLAN SHOULD BE ADJUSTED TO FINAL ELEVATIONS BY THE CONTRACTOR.
5. PIPE BEDDING MATERIAL SHALL BE IN ACCORDANCE WITH DC WATER SPECIFICATIONS.
6. THE CONTRACTOR SHALL BE RESPONSIBLE FOR PROVIDING ANY AND ALL TEMPORARY CONNECTIONS BETWEEN THE EXISTING AND NEW UTILITY SYSTEMS NECESSARY FOR MAINTAINING SERVICE.
7. THE CONTRACTOR SHALL CONDUCT TEST PITS TO VERIFY THE LOCATION AND ELEVATION OF ALL EXISTING UTILITY LINES AS WELL AS THE LOCATION AND ELEVATION OF THE PROPOSED TIE-IN POINTS PRIOR TO THE START OF ANY UTILITY CONSTRUCTION WORK.
8. ALL EXISTING LINES TO REMAIN THAT ARE DISTURBED BY THIS PROJECT SHALL BE REPAIRED/RELOCATED AS REQUIRED BY THE CONTRACTOR AT NO ADDITIONAL COST TO THE OWNER. THESE COSTS ARE CONSIDERED INCIDENTAL TO THE OTHER VARIOUS UTILITY CONSTRUCTION WORK.

ELEVATIONS ARE
RELATIVE TO FIELD LEVEL

FIELD LEVEL @ +22'-0"
ABOVE SEA
LEVEL

**PART B - NOT PART OF STADIUM
PUD SUBMISSION, DESIGN INTENT
SHOWN FOR REFERENCE ONLY**

**PUBLIC REALM - NOT PART OF PUD
SUBMISSION, DESIGN INTENT SHOWN
FOR REFERENCE ONLY**

**DISTRICT OF COLUMBIA RESPONSIBLE
FOR DESIGN OF PUBLIC REALM**

PROPOSED UTILITY PLAN

SCALE: 1"=30'

GRAPHIC SCALE

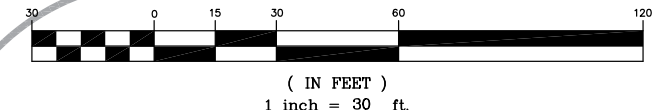

FOR REFERENCE ONLY - NOT FOR CONSTRUCTION

POPULOUS
Marshall Moya Design

POPULOUS
1000 17th Street NW
Washington, DC 20036
PRC 20-001

Principal Engineer: PRC
Senior Engineer: PRC
Mechanical Designer: PRC
Mechanical Consultant: PRC
Mechanical Director/Plumber: PRC
Civil Engineer: PRC
Electrical Engineer: PRC
Structural Engineer: PRC



DC UNITED SOCCER STADIUM

100 Potomac Avenue, SW
Washington, DC 20024

100% PUD SUBMISSION

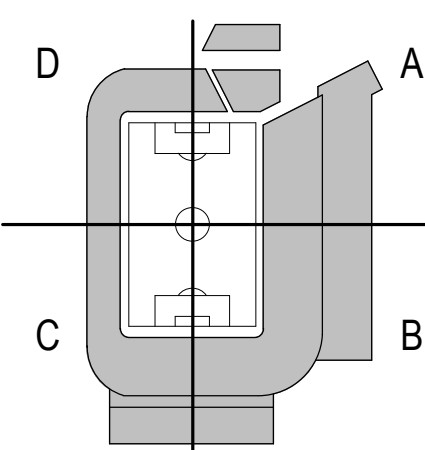

UTILITY PLAN

2.02



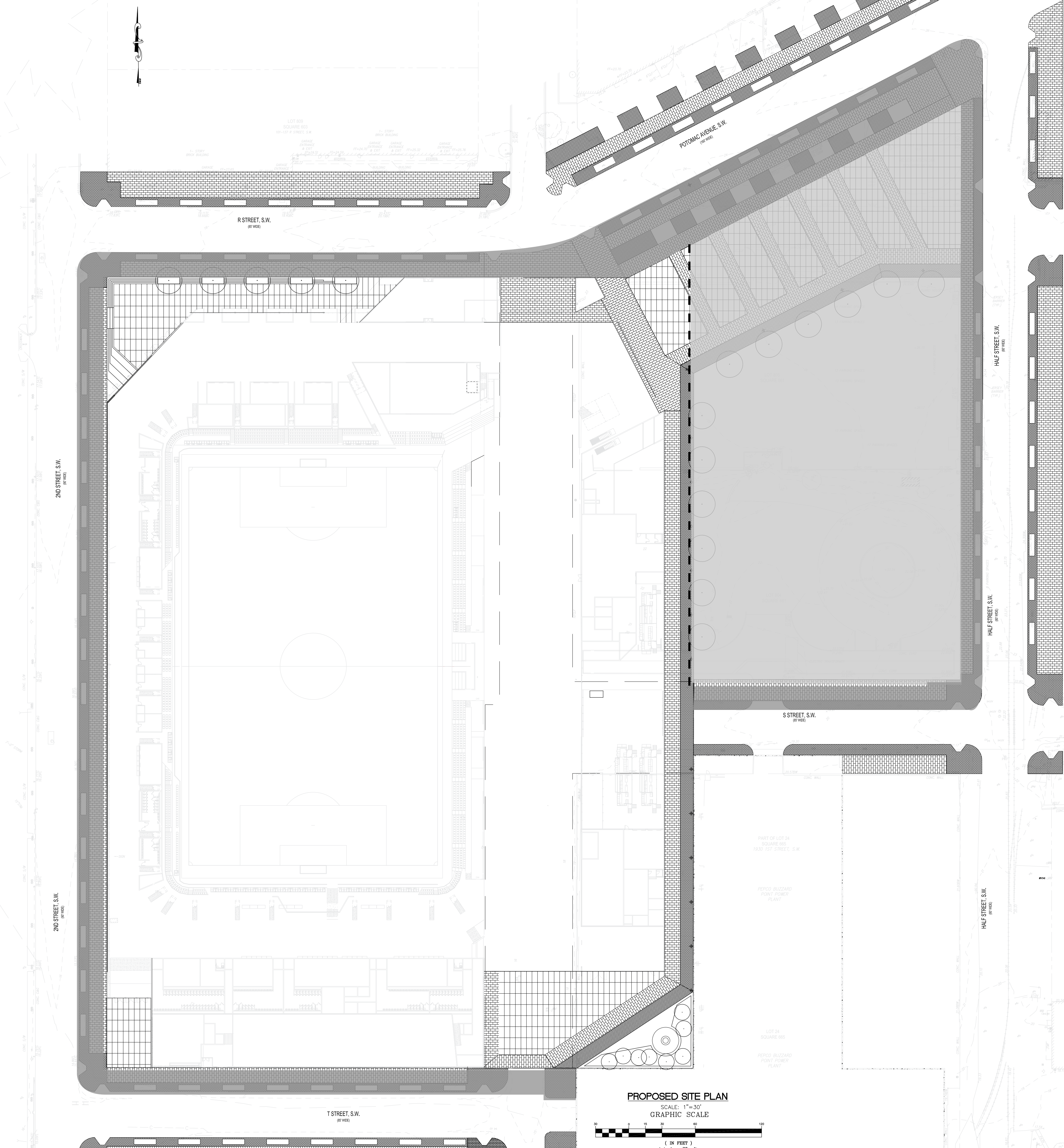

SITE PLAN NOTE:

1. EXISTING AND PROPOSED UTILITY INFORMATION HAS BEEN TURNED OFF FOR PLAN CLARITY.
2. WORK WITHIN THE EXISTING SURROUNDING STREETS IS THE RESPONSIBILITY OF OMPED/DOS.

**PART B - NOT PART OF STADIUM
PUD SUBMISSION. DESIGN INTENT
SHOWN FOR REFERENCE ONLY**

**PUBLIC REALM - NOT PART OF PUD
SUBMISSION, DESIGN INTENT SHOWN
FOR REFERENCE ONLY**

**DISTRICT OF COLUMBIA RESPONSIBLE
FOR DESIGN OF PUBLIC REALM**

PROPOSED SITE PLAN
SCALE: 1"=30'
GRAPHIC SCALE

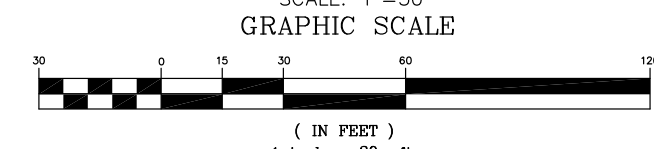

FOR REFERENCE ONLY - NOT FOR CONSTRUCTION

POPULOUS
Marshall Moya Design

POPULOUS
Architectural Firm
1000 15th Street, NW
Washington, DC 20004
PO 20-000
Principal Architect
RF
Principal Designer: JMD
RF
Mechanical Consultant
RF
Structural Consultant
RF
Civil Engineer
RF
Landscape Architect
RF
Electrical Consultant
RF



DC UNITED SOCCER STADIUM
100 Potomac Avenue, SW
Washington, DC 20024

100% PUD SUBMISSION

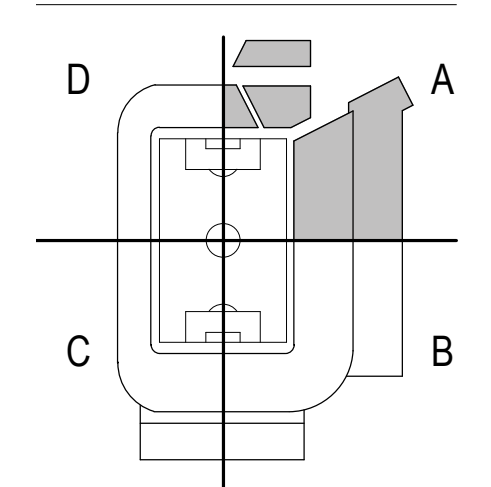





POPULOUS
ARCHITECTS
PROPOSED SITE PLAN

WORK SHEET NO. 02-03-51
2.03

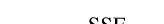
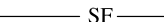

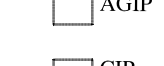
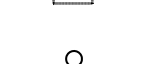
EROSION & SEDIMENT CONTROL LEGEND

-  SCE TEMPORARY STABILIZED CONSTRUCTION ENTRANCE
-  SSF SUPER SILT FENCE
-  SF SILT FENCE
-  LOD LIMIT OF DISTURBANCE
-  A-1 TEMPORARY EARTH DIKE
-  AGIP AT GRADE INLET PROTECTION
-  CIP CURB INLET PROTECTION
-  OR TEMPORARY RISER STRUCTURE W/TRASH RACK
-  SDP STORM DRAIN PIPE CONNECTION

SEDIMENT TRAPS			
TRAP	TYPE	DRAINAGE AREA	VOLUME REQUIRED
A	ST-II	3.14 Acre	11,300 CF
B	ST-II	2.35 Acre	8,460 CF
C	ST-II	2.97 Acre	10,692 CF

NOTES
 1. EXISTING BUILDINGS PREVIOUSLY DEMOLISED DOWN TO SLAB ON GRADE

PART B - NOT PART OF STADIUM PUD SUBMISSION, DESIGN INTENT SHOWN FOR REFERENCE ONLY

PUBLIC REALM - NOT PART OF PUD SUBMISSION, DESIGN INTENT SHOWN FOR REFERENCE ONLY

DISTRICT OF COLUMBIA RESPONSIBLE FOR DESIGN OF PUBLIC REALM

POPULOUS
 Marshall | Moya Design

POPULOUS
 1700 K Street, NW
 Washington, DC 20004
 (202) 462-1000
 www.populous.com



DC UNITED SOCCER STADIUM
 100 Potomac Avenue, SW
 Washington, DC 20024

100% PUD SUBMISSION

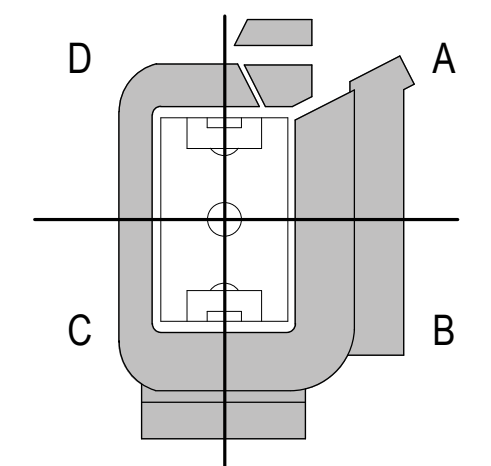

SEDIMENTATION AND EROSION CONTROL PLAN

2.04



FOR REFERENCE ONLY - NOT FOR CONSTRUCTION

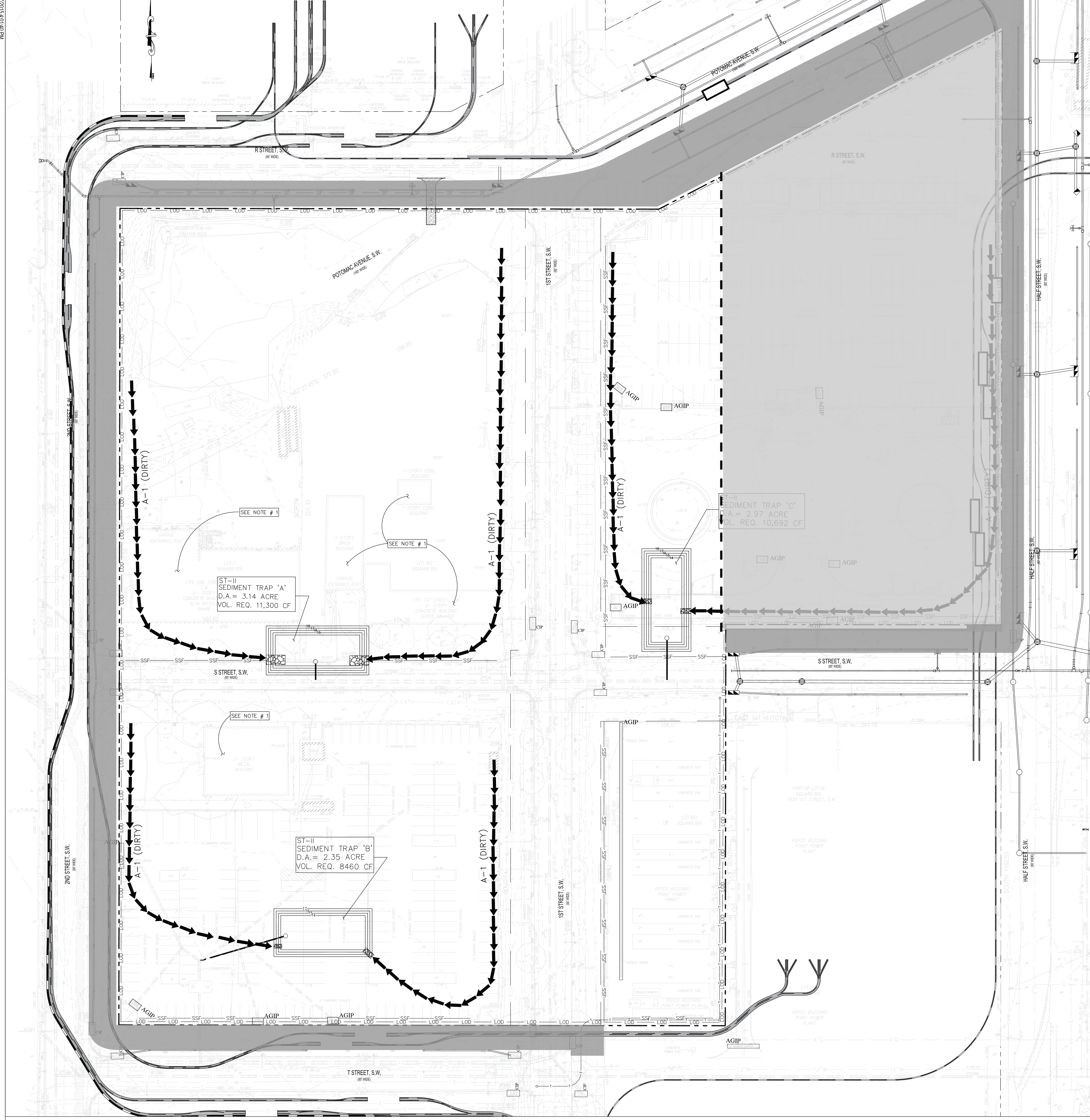

INITIAL EROSION AND SEDIMENT CONTROL PLAN

SCALE: 1"=30'
 GRAPHIC SCALE

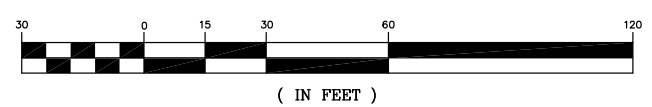

NO. 09-109-9102A

EROSION AND SEDIMENT CONTROL DETAILS		
DETAIL NUMBER	DESCRIPTION	SOURCE
1	STABILIZED CONSTRUCTION ENTRANCE	DCDOH - WPD
4	SILT FENCE	DCDOH - WPD
6C	CURB INLET PROTECTION (COG OR COS INLETS)	DCDOH - WPD
7A	FILTER BAG INLET PROTECTION CURBED ROADWAY	DCDOH - WPD
9	EARTH DIKE	DCDOH - WPD
10	TEMPORARY SURFACE	DCDOH - WPD
12	PIPE OUTLET SEDIMENT TRAP - ST I	DCDOH - WPD
15	PIPE SPILLWAY DESIGN	DCDOH - WPD
19	RISER BASE DETAIL	DCDOH - WPD
20	CONCENTRIC TRASH RACK AND ANTI-VORTEX DEVICE	DCDOH - WPD
23	SEDIMENT BASIN BAFFLES	DCDOH - WPD
32A	REMOVABLE PUMPING STATION	DCDOH - WPD
32B	SUMP PIT	DCDOH - WPD
33	PUMPED WATER FILTER BAG	DCDOH - WPD
33	SUPER SILT FENCE	MDE - WMA
34	PORTABLE SEDIMENT TANK (HORIZONTAL)	DCDOH - WPD
35	PORTABLE SEDIMENT TANK (VERTICAL)	DCDOH - WPD
74	TREE PROTECTION	DCDOH - WPD
-	STANDARD SYMBOLS	DCDOH - WPD
-	VEHICLE WASH RACK	DCDOH - WPD
-	MOUNTABLE ASPHALT BEAM	DOEE
-	BASIN DRAW-DOWN SCHEMATIC - HORIZONTAL DRAW-DOWN DEVICE	DCDOH - WPD
-	STREET SWEEPING	DOEE
-	STANDARD SPECIFICATIONS FOR DUST CONTROL	DOEE
-	DDOE SOIL EROSION AND SEDIMENT CONTROL PLAN GENERAL NOTES	DOEE
-	VEGETATIVE STABILIZATION	DOEE
-	STANDARD EROSION AND SEDIMENT CONTROLS MEASURES AND SEQUENCE	DOEE
APPENDIX Q	POLLUTION PREVENTION THROUGH GOOD HOUSEKEEPING	DOEE

EROSION AND SEDIMENT CONTROL DETAILS		
DETAIL NUMBER	DESCRIPTION	SOURCE
1	STABILIZED CONSTRUCTION ENTRANCE	DCDOH - WPD
4	SILT FENCE	DCDOH - WPD
6C	CURB INLET PROTECTION (COG OR COS INLETS)	DCDOH - WPD
7A	FILTER BAG INLET PROTECTION CURBED ROADWAY	DCDOH - WPD
9	EARTH DIKE	DCDOH - WPD
10	TEMPORARY SURFACE	DCDOH - WPD
12	PIPE OUTLET SEDIMENT TRAP - ST I	DCDOH - WPD
15	PIPE SPILLWAY DESIGN	DCDOH - WPD
19	RISER BASE DETAIL	DCDOH - WPD
20	CONCENTRIC TRASH RACK AND ANTI-VORTEX DEVICE	DCDOH - WPD
23	SEDIMENT BASIN BAFFLES	DCDOH - WPD
32A	REMOVABLE PUMPING STATION	DCDOH - WPD
32B	SUMP PIT	DCDOH - WPD
33	PUMPED WATER FILTER BAG	DCDOH - WPD
33	SUPER SILT FENCE	MDE - WMA
34	PORTABLE SEDIMENT TANK (HORIZONTAL)	DCDOH - WPD
35	PORTABLE SEDIMENT TANK (VERTICAL)	DCDOH - WPD
74	TREE PROTECTION	DCDOH - WPD
-	STANDARD SYMBOLS	DCDOH - WPD
-	VEHICLE WASH RACK	DCDOH - WPD
-	MOUNTABLE ASPHALT BEAM	DOEE
-	BASIN DRAW-DOWN SCHEMATIC - HORIZONTAL DRAW-DOWN DEVICE	DCDOH - WPD
-	STREET SWEEPING	DOEE
-	STANDARD SPECIFICATIONS FOR DUST CONTROL	DOEE
-	DDOE SOIL EROSION AND SEDIMENT CONTROL PLAN GENERAL NOTES	DOEE
-	VEGETATIVE STABILIZATION	DOEE
-	STANDARD EROSION AND SEDIMENT CONTROLS MEASURES AND SEQUENCE	DOEE
APPENDIX Q	POLLUTION PREVENTION THROUGH GOOD HOUSEKEEPING	DOEE

FOR REFERENCE ONLY - NOT FOR CONSTRUCTION

POPULOUS
Marshall Moya Design

POPULOUS
1000 Wisconsin Avenue, NW
Washington, DC 20007
Tel: 202.391.9000
www.populous.com



DC UNITED SOCCER STADIUM

100 Potomac Avenue, SW
Washington, DC 20024

100% PUD SUBMISSION

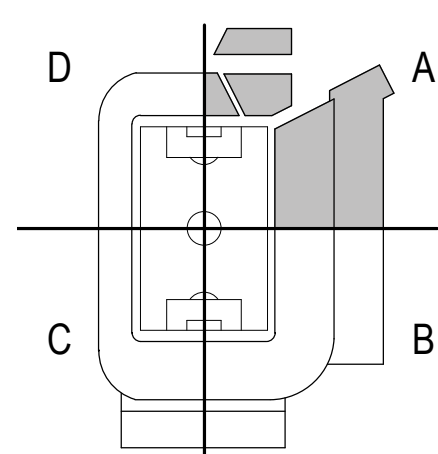

POPULOUS
1000 Wisconsin Avenue, NW
Washington, DC 20007
Tel: 202.391.9000
www.populous.com

EROSION AND SEDIMENT CONTROL SCHEDULE

2.05

